

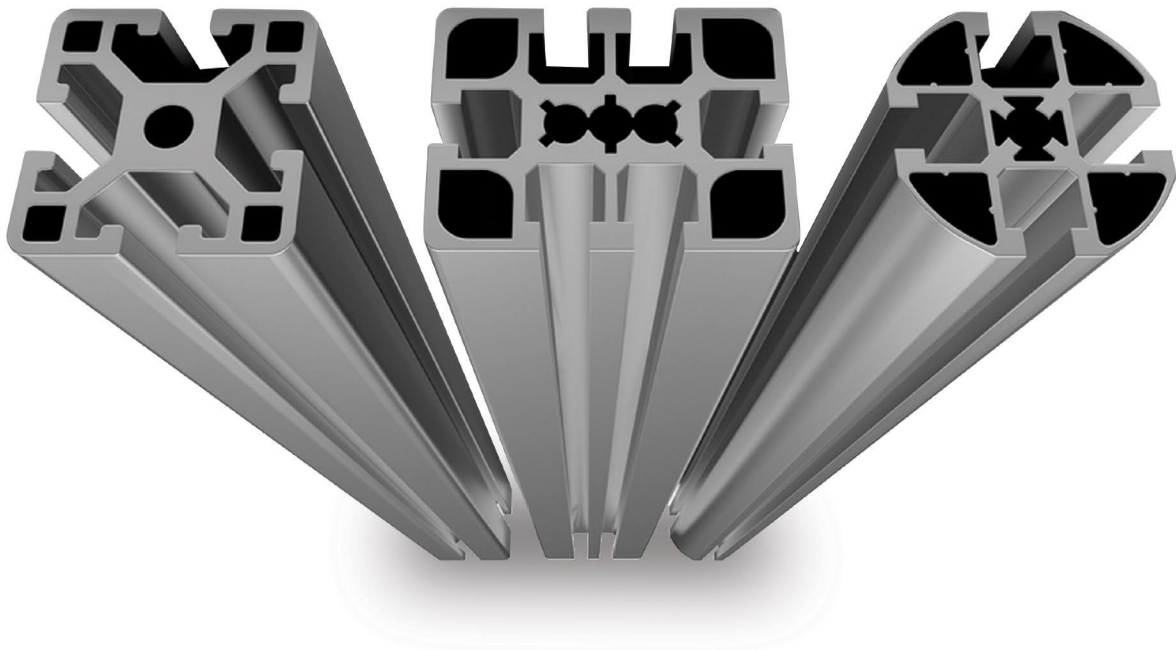

# PRINZAA

ALUMINIUM

A Division of M/s Prime Insulators Pvt Ltd.



**Quality • Consistency • Durability**

Premium Quality Aluminium Extruded Profiles, Section & EC Grade



[www.prinzaalu.com](http://www.prinzaalu.com)



## About Us

“PRINZAA” Aluminium is a new born star is North West India, Situated at Dalpur near Himmatnagar, in the state of Gujarat.

Aluminium extrusions are ubiquitous and essential for human progress and keeping this in mind, we M/s Prime Insulators (P), Ltd has started a new division called PRINZAA Aluminium and the facility is spread over 10 acres land situated very near to the NH-48 from Gujarat to New Delhi via Udaipur.

As our business mantra is diversification and cater to various sections of people. We are in Cotton Business, Manufacturing business of Tarpaulin, Electrical Insulators and now is Aluminium Sections & Profiles to cater to various categories of Industries, boards & various people.

Prinzaa Aluminium one of the primary producer of the aluminium extrusions in India, having world’s best class aluminium extrusion manufacturing plant. We are committed to quality and continuously strive for customer satisfaction.

We have started “Aluminium’ Sections manufacturing in the year 2022 with one extrusion press with 1000MT Capacity.

Prinzaa is an ISO 9001:2015 certified company with a wide range of products equipped with modern industrial equipment’s to accomplish high quality products, catering to the needs of customers. Foreseeing the vital role that Aluminium would play in the future, we invested in technology and quality assurance, working towards a position of undisputed leadership in Aluminium Extrusion.

Our “PRINZAA ALUMINIUM” facility is making premium products of Door & Window Sections with high precision and performance. Our passion is continuous improvement with outstanding performance in every profiles we supply to our customers and maximum full benefits to them and win their satisfaction and accolades.

As our products win the hearts of our esteemed clientele, we are expanding our capacity to 6000 MT/Annum by adding another 1000MTs Capacity Extrusion press. With its technology and manufacturing skills, Prinzaa is ready to make quality aluminium shapes of all sizes. Our customers can be assured that they will receive a quality product. Prinzaa today consists of over 4,48,000 square feet of manufacturing space and employees more than 350 people.

Prinzaa Aluminium will meet all the specific requirements of our customers and deliver outstanding quality products with reasonable rates.

## Vision & Mission

“Our vision is to continuously satisfy the customer’s requirements and deliver best quality aluminium products to the needy customers in a Quick Succession.”

“With Technologies, Intelligence, and Man power skill to become pioneer supplier and solution provider for quality aluminium extrusion products across Pan India and global markets by 2025, through sustainable industrial and business development”

## Quality Accreditation



ISO 9001: 2015 certified.

## History & 25 Years of Industrial Experience

01 **1979**

Our Journey with ceramic Industry has started in the year 1979 with our first crockery - manufacturing unit named as “Ghansyam Ceramics”.

02 **1997**

we did not stop here we have started the tiles manufacturing unit in the year 1997 with unique brand name “SAHARA TILES”.

03 **2002**

we have started manufacturing unit called as “CRYSTAL GLAZES”.

04 **2003**

we have started floor tile manufacturing facility with the same brand name mentioned above.

05 **2006**

we have established LT& HT Insulators Manufacturing unit M/s Prime Insulators Pvt Ltd with unique brand name “PIPL” insulators to create an enduring benchmark in the insulator industry.

06 **2022**

we unveiled a new full-fledged aluminium manufacturing plant under roof of Prime Insulators Pvt Ltd and named as “PRINZAA ALUMINIUM”.

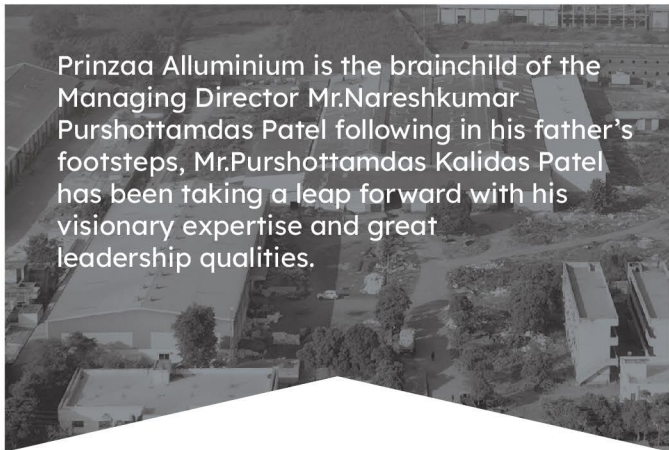

Prinzaa Alluminium is the brainchild of the Managing Director Mr.Nareshkumar Purshottamdas Patel following in his father’s footsteps, Mr.Purshottamdas Kalidas Patel has been taking a leap forward with his visionary expertise and great leadership qualities.

## Infrastructure / Plant & Machinery

Prinzaa has aluminium extrusion presses installed with latest technology that can produce extrusion of 6000 metric tons of aluminium per annum. This makes Prinzaa able to meet all kinds of requirements of aluminium work in its entirety.

## Foundry/ Billet Casting facility (Hot Top Casting):

We have in-house foundry with controlled heating systems for melting.

## Extrusion

Prinzaa specialises in the production of precision aluminium extrusions and a large range of surface finishing. Our experienced production personnel manage the entire extrusion process to deliver cost-effective quality aluminium extrusions. Our state-of-the-art facilities are capable of producing complex aluminium profiles to meet individual customer requirements and expectations. Our large range of press options enable us to produce complex lightweight profiles and large extrusions weighing.

To complement our extrusion and finishing capabilities, we offer a complete one-stop solution for companies requiring more than just extrusions.

Extrusion die development is a core element of the extrusion process. Our dies are constructed from high quality materials and through qualified partner companies employing the same quality assurance procedures. Our experienced CAD designers, machine processing and engineering techniques have enabled us to perfect the production of extrusion dies with the right balance of metal flow and shape that is essential in producing profiles that meet the most demanding specifications.

## Anodising

Anodising enhances the natural qualities of aluminium still further; it permits a strongly contemporary finish with incomparable corrosion and abrasion resist. Anodised aluminium has enhanced durability and weather-resistant properties making it ideal for a large number of applications particularly in the building and construction industries. Prinzaa is equipped with horizontal anodising facilities and offer customers a wide range of colours. The thickness of the aluminium oxide 'anodised' coating can be varied by the processing time to suit different applications.

To improve the aesthetics of our profiles, we are also taking up to anodizing activities and powder coating facility as per customer requirements.

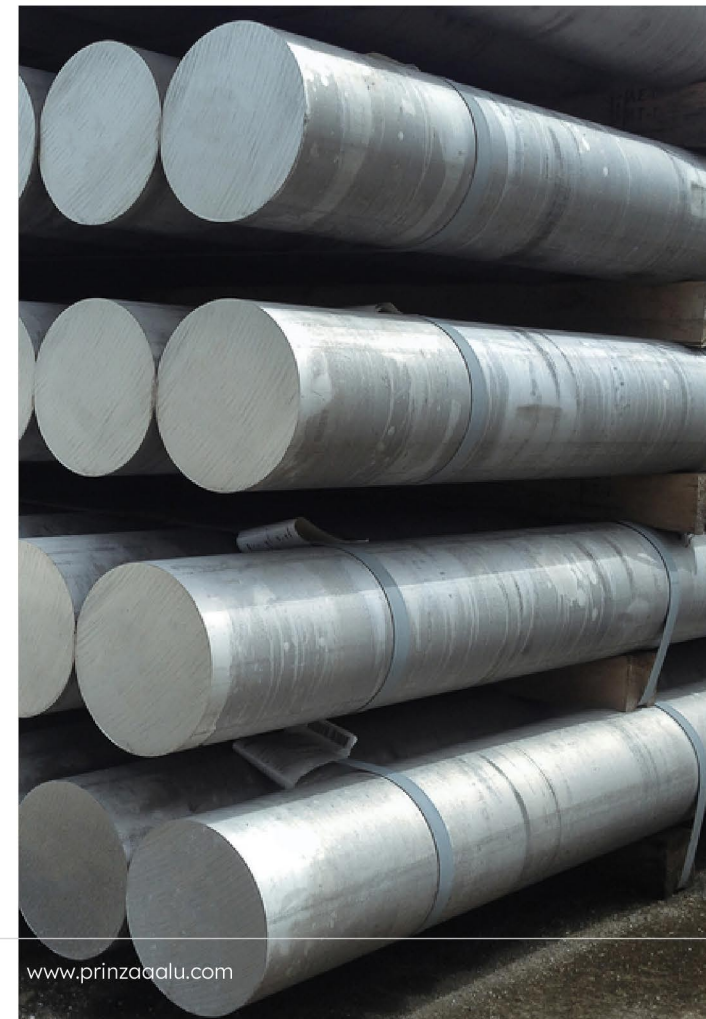
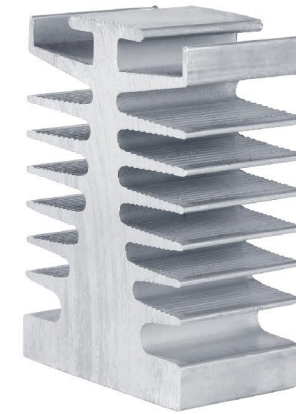

## Strengths

- In-house Die Maintenance with necessary tools & facilities.
- Having highly skilled, motivated and disciplined team work.
- Minimize cost by reducing wastes, re-work and scrap.
- Commitment - to do things in organized way and deliver in time for the outmost satisfaction of our customers.
- Proven Performance.
- More than 1000 Dies available.

## Why to Choose Prinzaa & Advantages

- Damage-free sections & aesthetic look.
- Excellent traceability & accurate weights.
- Act with urgency to deliver what we promise.
- High Durability & Easy Installation.
- Eco friendly and Recyclable

## Alloys Range

Prinzaa can offer below range of different alloys.

We currently manufacture all profiles of AA 6005, 6060, 6061 (65032), 6063 (63400) 6082 (63430), 6084, 6262, 6351(64430), 62243

EC Grade alloys -E1E (19051) and E91E (63401)

Flats- 195 x 110 mm

## Products / Aluminium Applications

We have a superior surface finish with exact dimensions and meet all stringent quality standards. Aluminium's formability, high strength-to-weight ratio, corrosion resistance, and ease of recycling, makes it the ideal material for a wide range of applications.

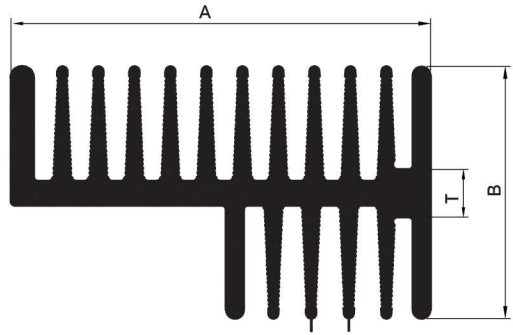

Section NO.	A	B	T	Wt./12'
9001	57.5	34.5	6.0	6.9 - 7.2

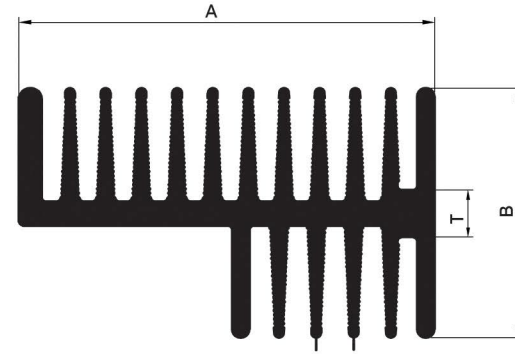

Section NO.	A	B	T	Wt./12'
9005	57.5	34.5	6.0	6.9 - 7.2

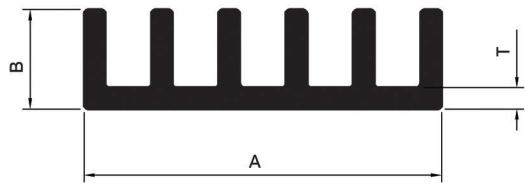

Section NO.	A	B	T	Wt./12'
9008	50.5	14.0	3.0	3.5 - 3.8

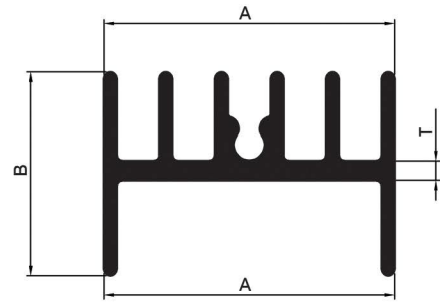

Section NO.	A	B	T	Wt./12'
9002	22.5	16.0	1.6	1.0 - 1.3

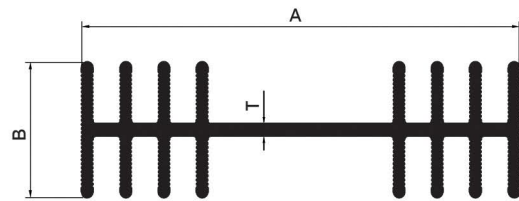

Section NO.	A	B	T	Wt./12'
9006	91.7	28.4	2.4	6.0 - 6.3

## Heat Sink

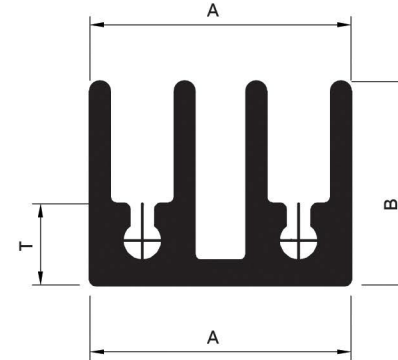

Section NO.	A	B	T	Wt./12'
9003	16.0	12.5	5.0	0.9 - 1.2

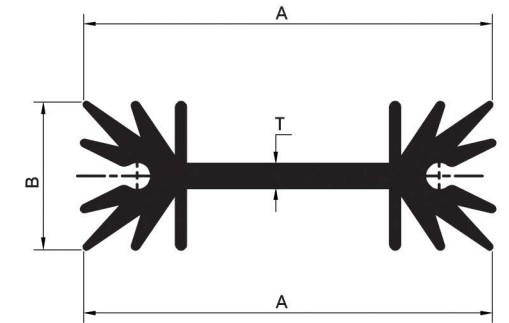

Section NO.	A	B	T	Wt./12'
9004	35.0	12.4	2.0	0.85 - 1.00

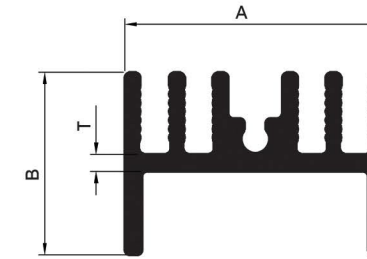

Section NO.	A	B	T	Wt./12'
9007	15.0	10.5	1.0	0.55 - 0.6

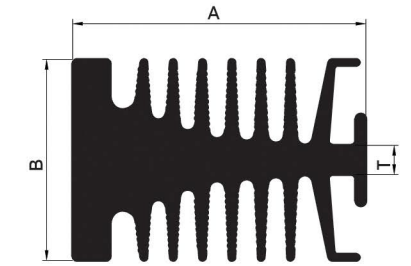

Section NO.	A	B	T	Wt./12'
9010	70.0	48.0	7.0	18.1 - 18.4

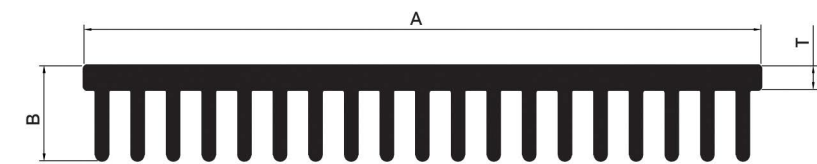

Section NO.	A	B	T	Wt./12'
9009	142.5	20.2	5.0	13.9 - 14.1



**PRINZAA**  
ALUMINIUM



**Mr.NARESHKUMAR PATEL**  
Managing Director

Mob: +91 98795 21374

Email: nareshpatel@prinzaaalu.com

**Mr. Jayendra Patel**  
Finance Director

Mob: +91 98250 46285

Email: info@prinzaaalu.com

**Mr.AJAY SINGH RATHORE**  
Marketing Manager

Mob: +91 82220 67005  
+91 91137 81304

Email: sales@prinzaaalu.com



**PRINZAA ALUMINIUM**

(A Division of M/s Prime Insulators Pvt Ltd.)

Ceramic Zone, Block No. 134/P2,

At&Po : Dalpur, Ta : Prantij, Dist : S.K.

Pin : 383120, (Gujarat) India



[www.prinzaaalu.com](http://www.prinzaaalu.com)